

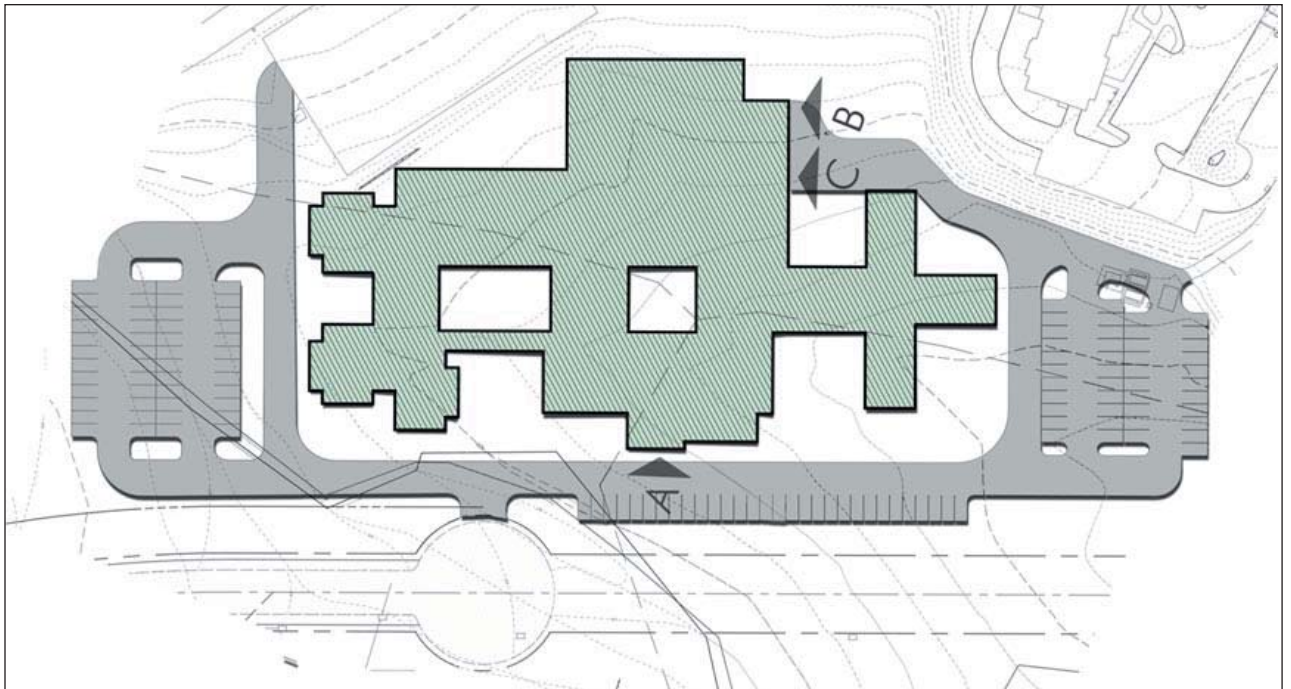

YORK COUNTY YOUTH DEVELOPMENT CENTER

Facility Assessment and Programming Study

York, Pennsylvania



The York County Youth Development Center requires a facility assessment and programming study as they consider expansion of their existing facility. SGA completes the facility assessment portion of the study and brings on Carter Goble as a programming consultant to execute programming and planning. Expanded building area will be determined based on the results of the study.