

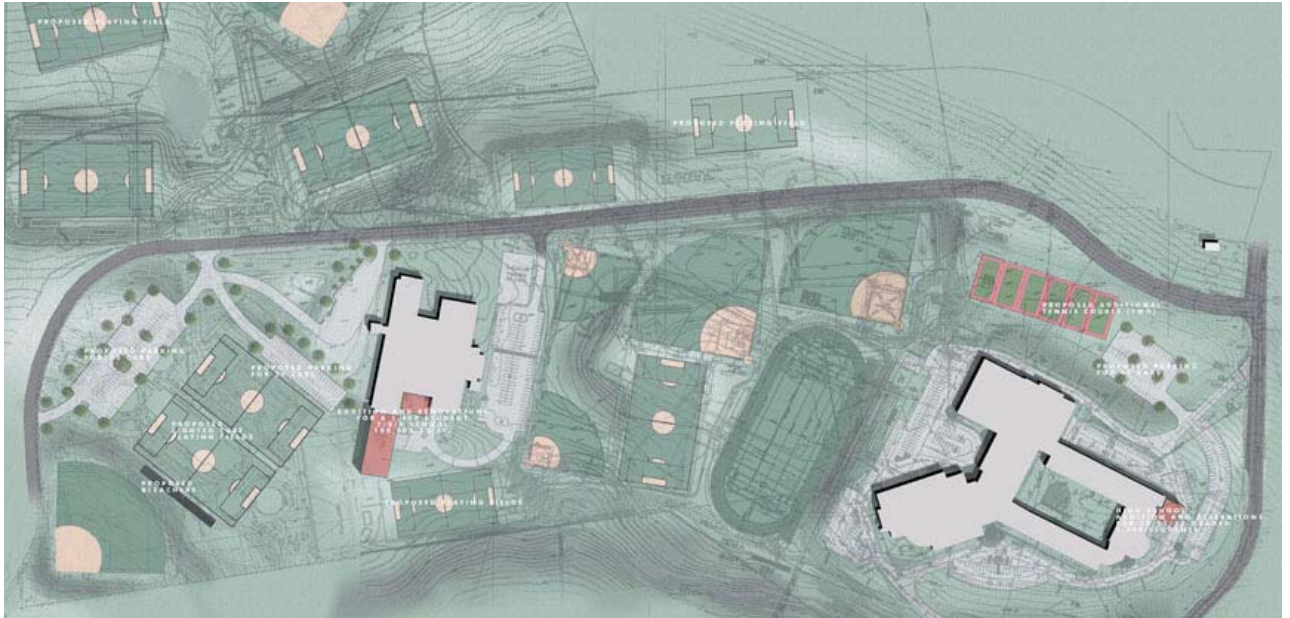

TWIN VALLEY SCHOOL DISTRICT

Educational Master Plan

Elverson, Pennsylvania



SGA completes a comprehensive master plan of a school district whose growth will nearly double the student population within a very short period of time. Numerous options are explored during the study and the following projects are proposed to address the District's growth issues:

- Additions and renovations to the High School
- Additions and renovations to the Middle School
- Construction of a new Physical Education Building
- Construction of a new school for Grades 5-6

Twin Valley retains SGA to complete the additions and renovations to the High School and Middle School as well as to design the new Physical Education Building. The new school for Grades 5-6 is being considered as a potential future project.

Estimated completion August 2007 through August 2010